

American Planking Shiplap Installation Instructions

Read Carefully Before Installation

Step 1) Open shiplap in the room it will be installed. Wood **MUST** acclimate to the conditions of the room for a minimum of **72 hours**.



Proper Brad / Nail Placement For 1 x 6 and 1 x 8

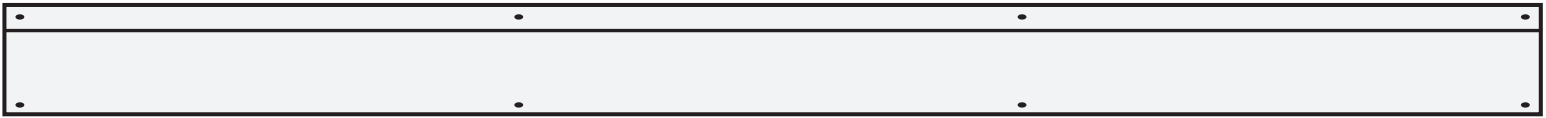

Step 3) Recommended installation for shiplap is to be nailed with a brad/nail gun or a hammer and finishing nails. Recommended brad/nail length is 2 1/2". Apply brads/nails approximately 1/2" from outside edges of boards and into studs when possible (see above diagram). If a brad gun is not available, use 8d x 2 1/2" finish nails along with a nail set to set the nail head slightly below the surface of the board. It is not recommended to apply wood putty to the nail holes since the putty will collect in the weathered wood grain.

Note: For both horizontal and vertical installations, we recommend securing shiplap to the wall with brads/nails through the **tongue** of the board first, then through the **face**.

Horizontal Installation

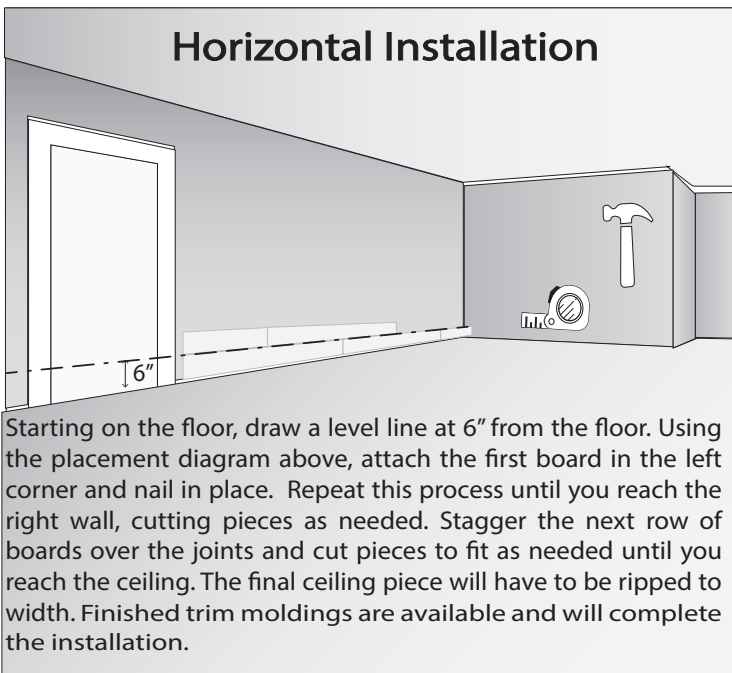

Vertical Installation Wainscoting

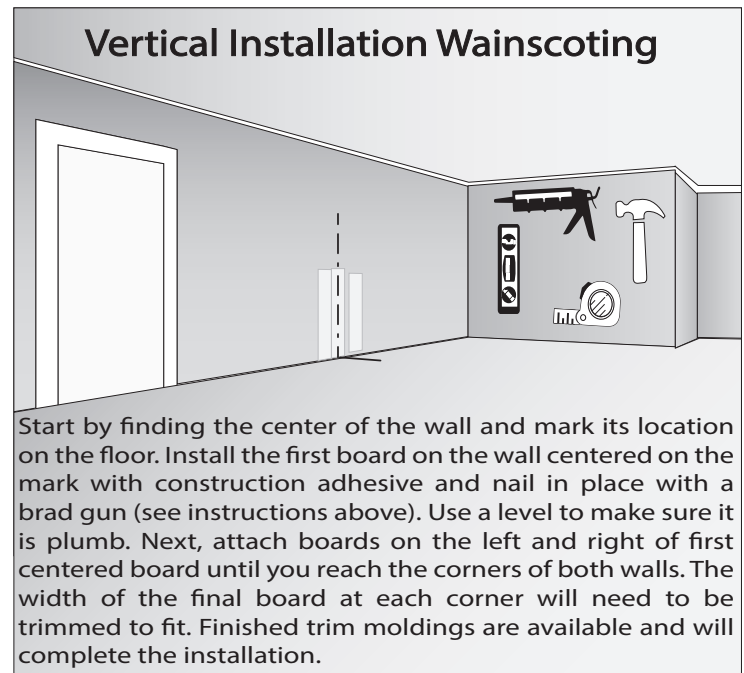

American Planking
520 Salem Ave.
Holly Springs, MS 38635
AmericanPlanking.com